

ST180

Standard

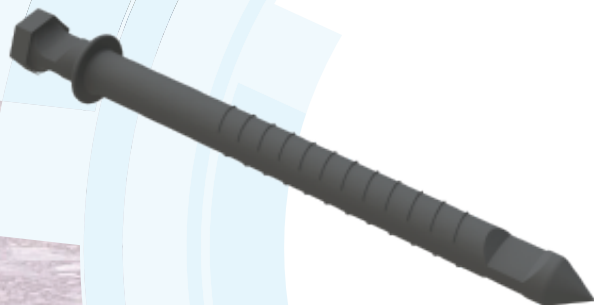

Tie Length:	10.25 in / 260 mm
Embedment Depth:	1.5 in / 38 mm (Head) 1.75 in / 44 mm (Tip)

Diameter Through Foam:	0.62 in / 15.9 mm
Insulation Thickness:	6.25–7 in / 160–180 mm
Fascia Thickness:	2–4 in / 50–100 mm

Ultimate Tensile/Pullout ¹ :	1,660 lb / 7.38 kN
-----------------------------------------	--------------------

Shear Strength:	1,700 lb / 7.56 kN
-----------------	--------------------

Ultimate Panel Shear Capacity/Tie:	780 lb / 3.47 kN
------------------------------------	------------------

Alkaline Resistance:	Excellent ²
----------------------	------------------------

Impact Resistance:	Excellent ³
--------------------	------------------------

Fire Performance:	Resist 300-lb tension load for over 90 minutes when fire tested per Section 7.4.3 of ASTM E1512-01
-------------------	----------------------------------------------------------------------------------------------------

Thermal Conductivity:	2.3 Btu-in/hr-ft ² °F 0.38 W/m°K
-----------------------	------------------------------------------------

¹ Concrete f'_c = 3,000 psi

² 99.1% retained strength after 3,000 hours of conditioning in pH12 solution

³ The un-notched Izod Impact testing: 21 ft-lb/in (1100 J/m)

DISCLAIMER OF LIABILITY: It is the sole responsibility of the contractor to install the HK ties in accordance with these published instructions. The presence of an HK Composites representative at the job site does not relieve contractor from the responsibility to follow these published installation instructions. HK COMPOSITES IS NOT RESPONSIBLE FOR ANY LIABILITY RESULTING FROM A FAILURE TO FOLLOW THESE INSTRUCTIONS. Our recommendations should not be taken as inducements to infringe on any patent or violate any law, safety code or insurance regulation.

U.S. Patents 5,519,973 5,830,399 5,987,834 5,809,723 6,112,491 | Canadian Patent 2,187,284 | Australian Patent 687,367 | European Patent 0745265 | Mexican Patent 201,274 | Chinese Patent ZL 95192498.2 | Japanese Patent 3,604,14

© Copyright 2020 HK Composites. All rights reserved.
Pub. No. HK-ST, Nov 2020.

Made in the USA 

Low-Conductivity Wall Tie

APPLICATION

Pre-cast, pre-stressed, and tilt-up for composite insulated concrete sandwich panels

INSTALLATION

See installation instructions
Pub. No. HK-ST-II before using

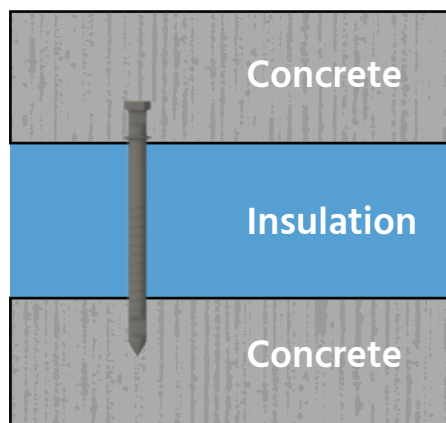

CONTACT US



Toll-Free: 1-800-430-6316
International: 801-763-0907



926 S Auto Mall Dr, Ste 4
American Fork, UT 84003



hkties.com

HK